

KNOWLEDGE BASE ARTICLE

Custom Search Page for SharePoint Online



Disclaimer

For the purposes of this Disclaimer:

- **Company** (referred to as either "the Company", "We", "Us" or "Our" in this Disclaimer) refers to Vitextra SIA, LV-1009 Riga, Matise iela 61 - 25.
- **Document** refers to the Knowledgebase Article.
- **You** means the individual accessing the Document, or the company, or other legal entity on behalf of which such individual is accessing or using the Document, as applicable.
- **Website** refers to Vitextra, accessible from <https://vitextra.com>

Disclaimer

The information contained in the Document is for general information purposes only.

The Company assumes no responsibility for errors or omissions in the contents of the Document.

In no event shall the Company be liable for any special, direct, indirect, consequential, or incidental damages or any damages whatsoever, whether in an action of contract, negligence, or other torts, arising out of or in connection with the use of the contents of the Document. The Company reserves the right to make additions, deletions, or modifications to the contents in the Document at any time without prior notice.

Errors and Omissions Disclaimer

The information given by the Document is for general guidance on matters of interest only. Therefore, errors can occur even if the Company takes every precaution to ensure that the Document's content is current and accurate. Plus, given the changing nature of laws, rules, and regulations, there may be delays, omissions, or inaccuracies in the information contained in the Document.

The Company is not responsible for any errors or omissions, or for the results obtained from the use of this information.

Fair Use Disclaimer

The Company may use copyrighted material that the copyright owner has not explicitly authorized. The Company is making such material available for criticism, comment, news reporting, teaching, scholarship, or research.

The Company believes this constitutes a "fair use" of any such copyrighted material as provided for in section 107 of the United States Copyright law.

If You wish to use copyrighted material from the Document for your own purposes that go beyond fair use, You must obtain permission from the copyright owner.

"Use at Your Own Risk" Disclaimer

All information in the Document is provided "as is", with no guarantee of completeness, accuracy, timeliness or of the results obtained from the use of this information, and without warranty of any kind, express or implied, including, but not limited to warranties of performance, merchantability and fitness for a particular purpose.

The Company will not be liable to You or anyone else for any decision made or action taken in reliance on the information given by the Service or for any consequential, special or similar damages, even if advised of the possibility of such damages.

Contact Us

If you have any questions about this Disclaimer, You can contact Us by email: support@vitextra.com.

Table Of Contents

Create New Page	4
Web Part Configuration	5
Mode	5
Appearance	6
Filtering	7
Sorting	7
Item Layout	8
Item Actions	8
Search Settings	8
Terms	10

The Smart Search is a client-side web part based on **SharePoint Framework** (SPFx) and designed for SharePoint Online and Microsoft Teams. Once the web part is deployed, it immediately becomes available for use within SharePoint Online and **Microsoft Teams**.

This article describes how to set up a search page and configure [Vitextra Smart Search](#) web part to create a custom search results page for **SharePoint Online** from scratch.

Create New Page

Open SharePoint site where you need to set up a search results page. Select **+** **New** and then select **Page**.

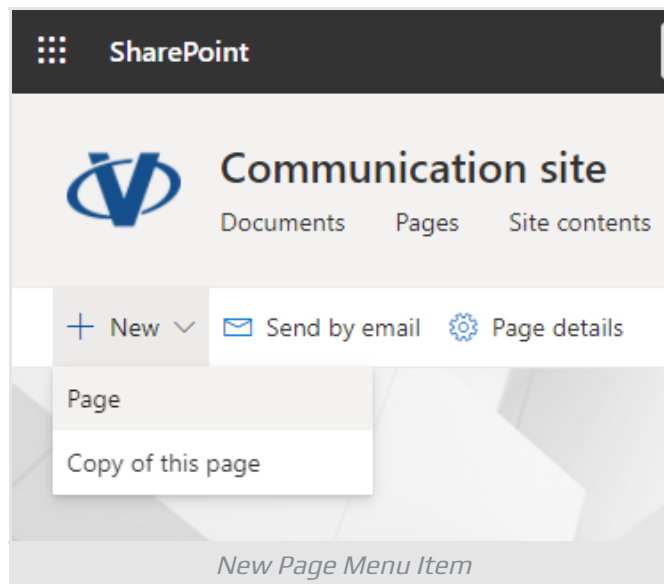

In the dialog, select the template you prefer and click **Create page** button.

Tip

Vitextra Smart Search supports a single app part page. You can switch to **App** tab and select **Smart Search** to create a new single app page.

On the new page, select the circled **+** icon. Scroll down and select **Smart Search** in the list of available web parts.

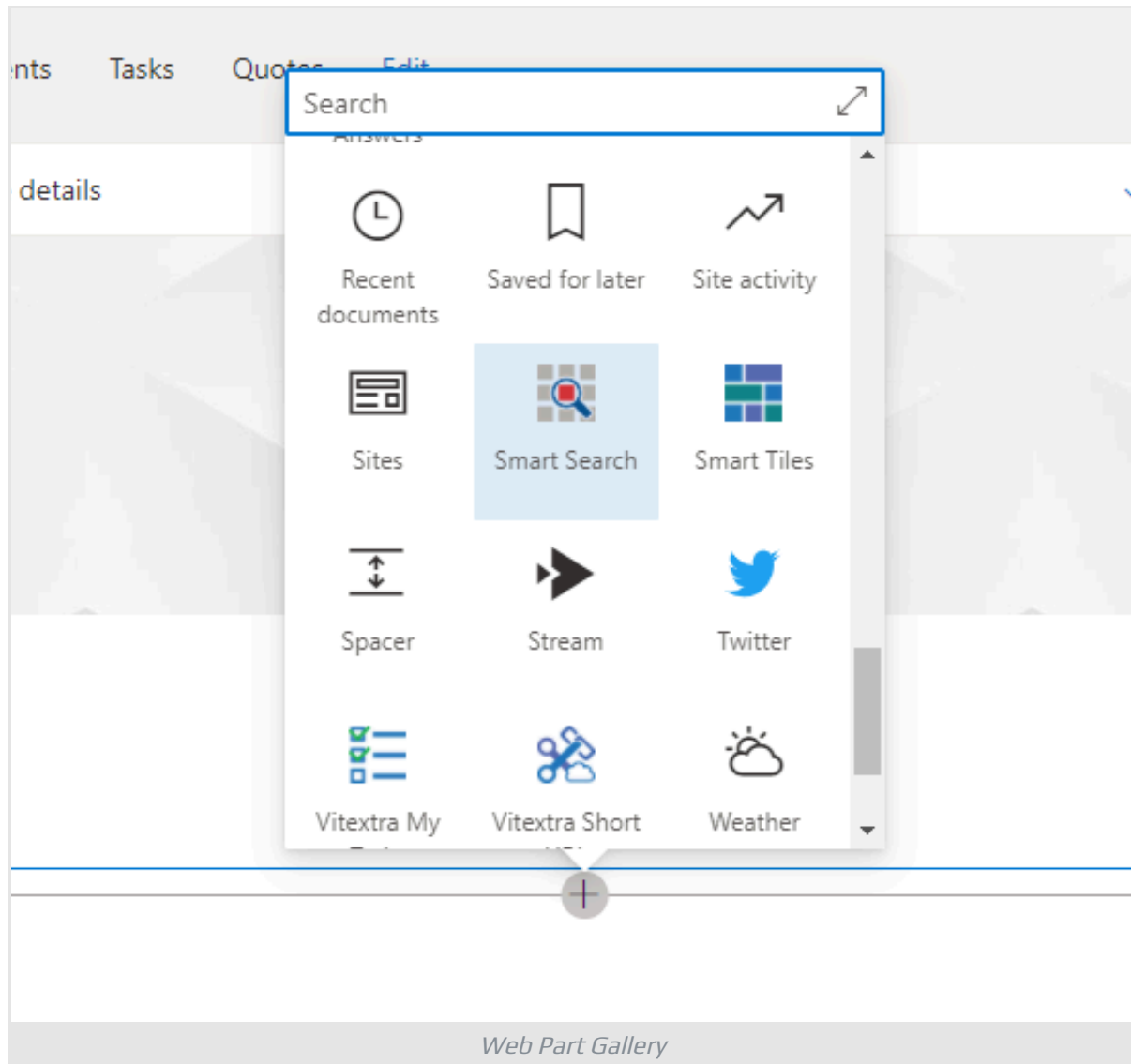

Web Part Configuration

Open configuration page of the Smart Search web part.

Mode

The Smart Search supports two modes of operation:

- **Single Source.** Choose one of the built-in search sources to narrow the search scope. Tabs are not presented in this mode.
- **Multiple Sources (Tabs).** Users can switch between selected sources.

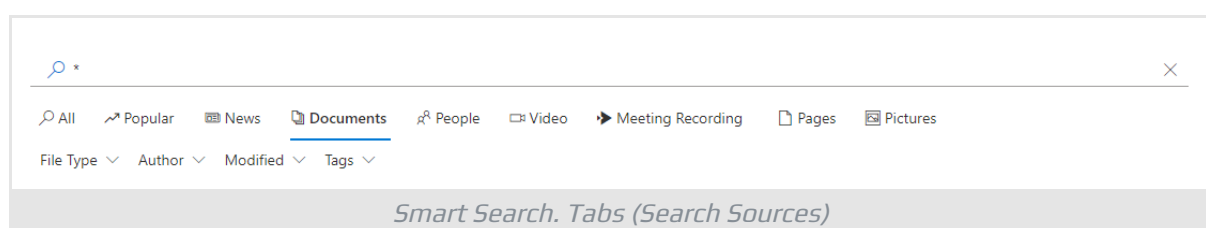

 **Note**

To hide icons in tab caption clear **Icon** field in the search resources panel.

Appearance

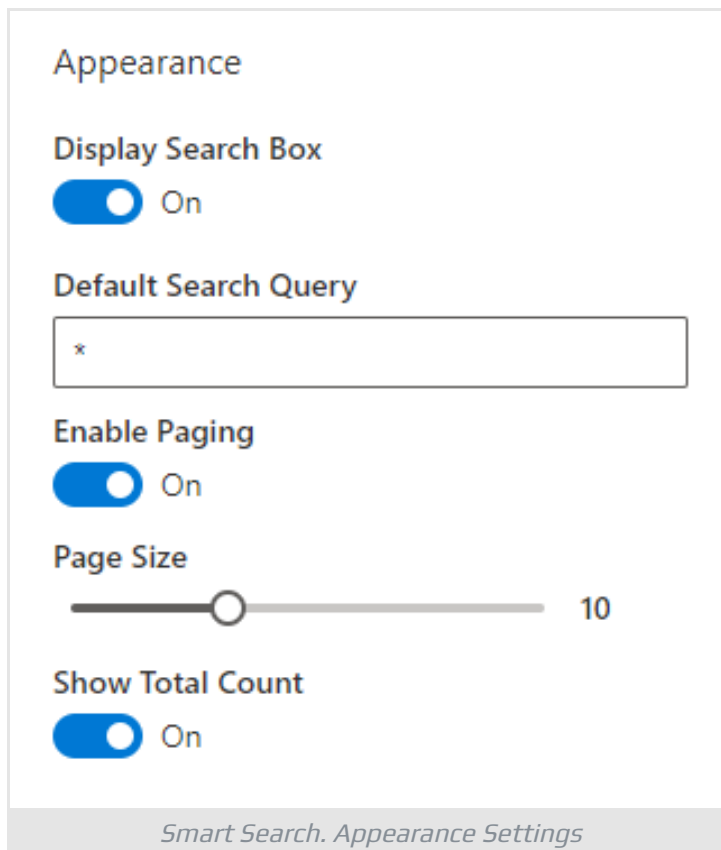

Appearance

Display Search Box
 On

Default Search Query

Enable Paging
 On

Page Size
 10

Show Total Count
 On

Smart Search. Appearance Settings

The settings below are to manage the appearance of the web part.

Display Search Box. Show or hide the search box.

 **Tip**

The web part uses the search query from the top header search bar if it's not empty.

Default Search Query. Search query to perform a search if search box value is blank or the search box is hidden.

Enable Paging. Show or hide pagination.

Page Size. Number of items to show per page.

Show Total Count. Display total number of search results.

Filtering

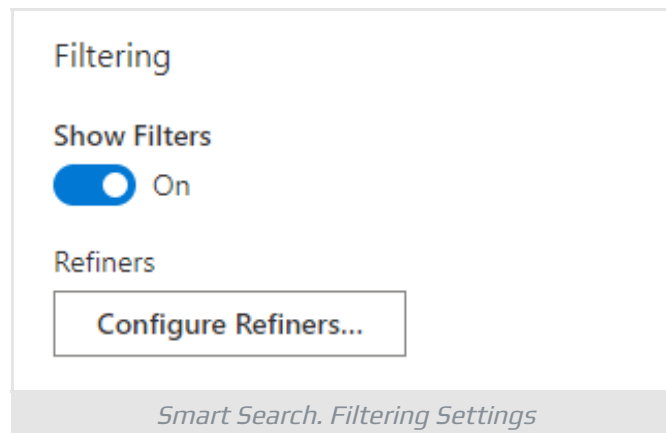

Select **Show Filters** to enable the refinement panel.

To choose which fields will be available for filtering and set their order, choose the **Configure Refiners** button.

Tip

If the refinement panel is enabled users can filter search results by tag by clicking it in the list.

Sorting

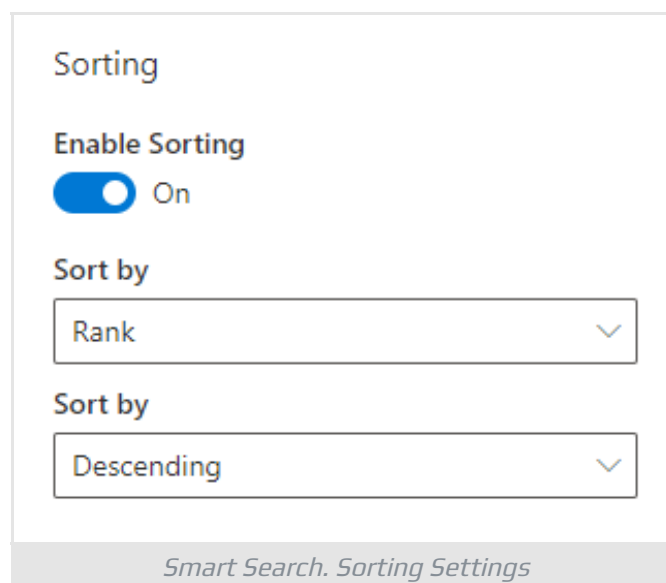

Select **Enable Sorting** to set default sorting of the search results.

Note

Sorting is not applicable for **Popular** and **Recently Changed Items** data sources.

Item Layout

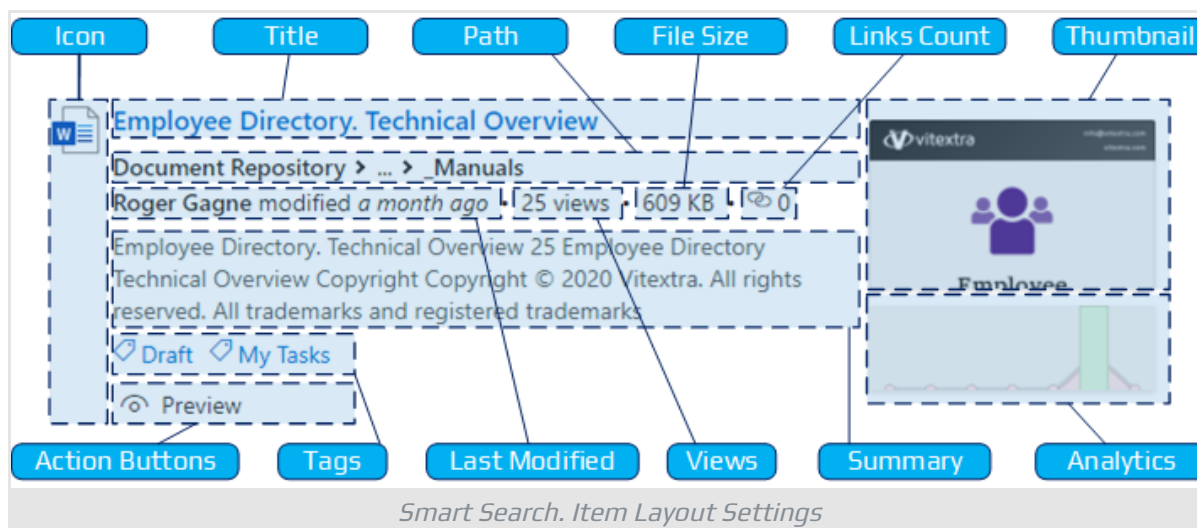

The search result item has twelve elements to show information. You can show or hide each of them except the Title. Also, you can select the length of the summary (from 100 to 300 symbols).

Item Actions

The Smart Search provides three actions for users to perform keeping the context and no need to open additional browser tabs:

- **Download**
- **Preview** for a document to open it in the dialog window
- **Play** for video content to start playing it in the dialog

Search Settings

Go to site settings and select **Search Settings** under **Site Collection Administration** heading:

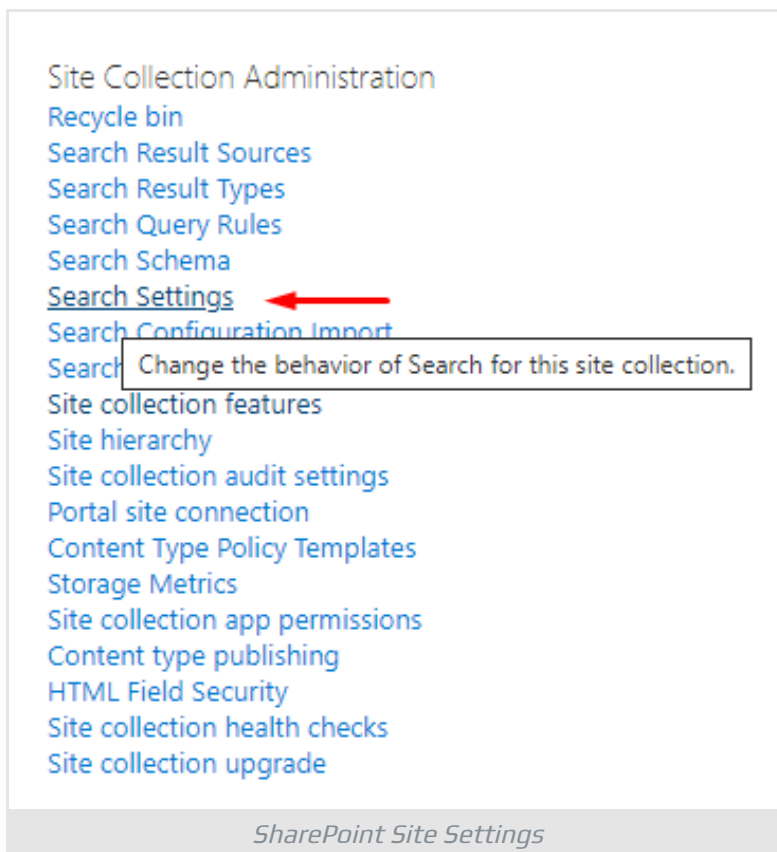

Type in server-relative URL to the new search page in the **Results page URL**:

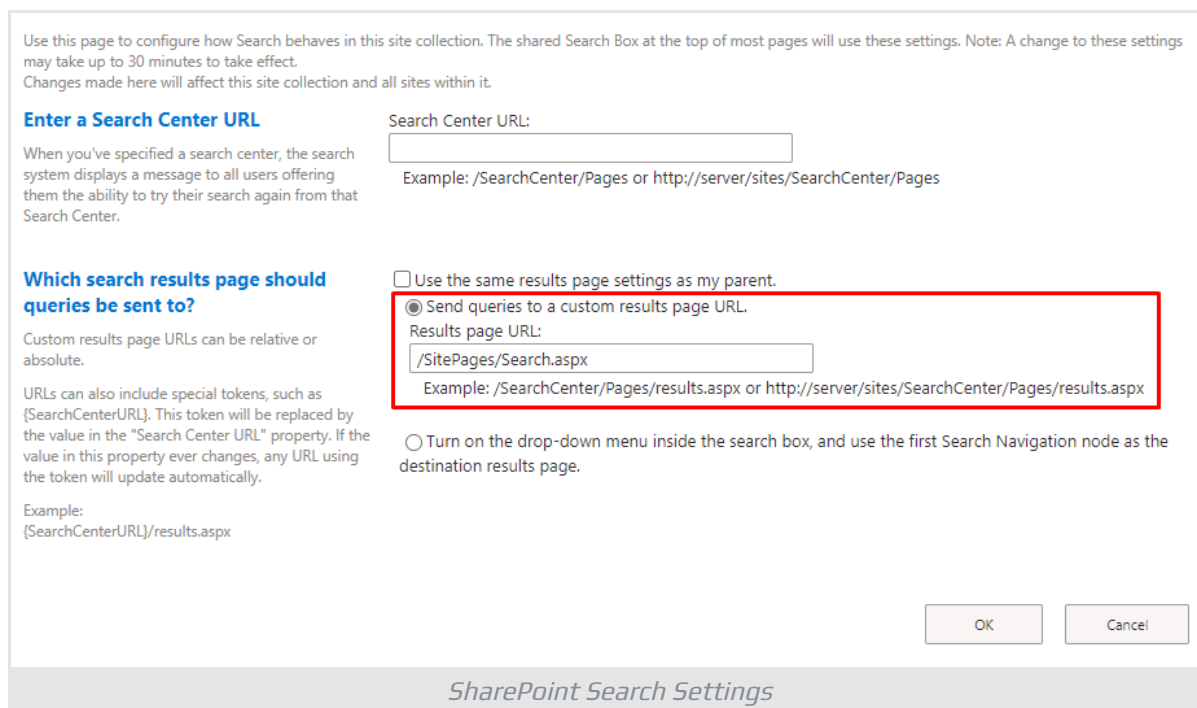

It may take up to 5 minutes for the change to be applied. After that, SharePoint will redirect all search requests to the new page.

Terms

Microsoft Teams

A chat-based collaboration platform for business communications with useful features for online meetings, live events, document sharing.

SharePoint Framework (SPFx)

Model for building client-side web-part, components, and extensions for SharePoint Online, SharePoint On-premises, and Microsoft Teams. SPFx customizations are based on JavaScript and support Modern UI natively.

SharePoint Online

Cloud version of SharePoint, a web-based collaborative platform within Microsoft 365 provides an extensive range of capabilities to store, share, and manage digital information, content, and knowledge of an organization.